

# Grow Tent Assembly Instructions



## STEP 1:

Create Floor and Roof by placing "A" poles together using corners

### NOTE:

Firmly push poles completely into corner pieces

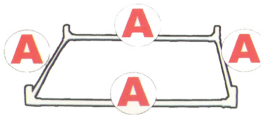

## STEP 2:

Attach four "B" poles to Floor part

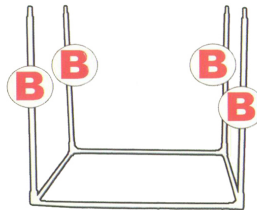

## STEP 3:

Attach four "C" poles to Roof part

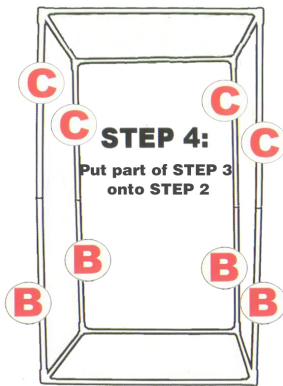
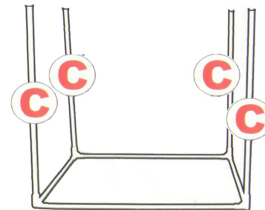

## STEP 4:

Put part of STEP 3 onto STEP 2

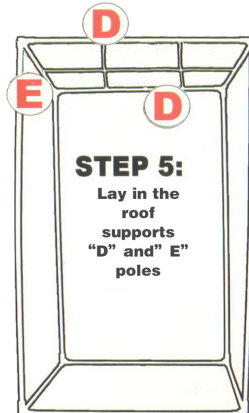

## STEP 5:

Lay in the roof supports "D" and "E" poles

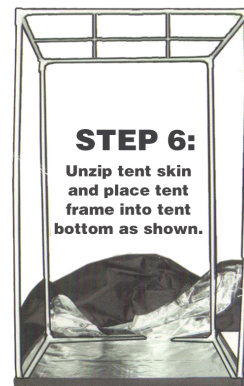

## STEP 6:

Unzip tent skin and place tent frame into tent bottom as shown.

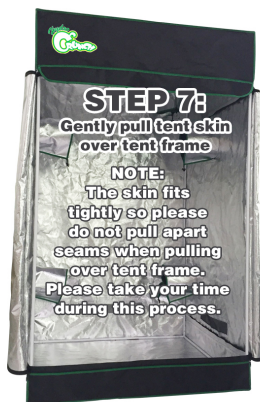

## STEP 7:

Gently pull tent skin over tent frame

### NOTE:

The skin fits tightly so please do not pull apart seams when pulling over tent frame. Please take your time during this process.



## STEP 8:

Put floor insert inside tent. Use the straps to hold the floor insert to poles.



## STEP 9:

Zip up the door to complete

**Congratulations! Your grow tent is now created.**  
**Please add on lightings, ventilation, plants, and start growing.**  
**For more products please visit [www.HydroCrunch.com](http://www.HydroCrunch.com)**

60\*60\*80in

